

EXTERIOR CONCEPT

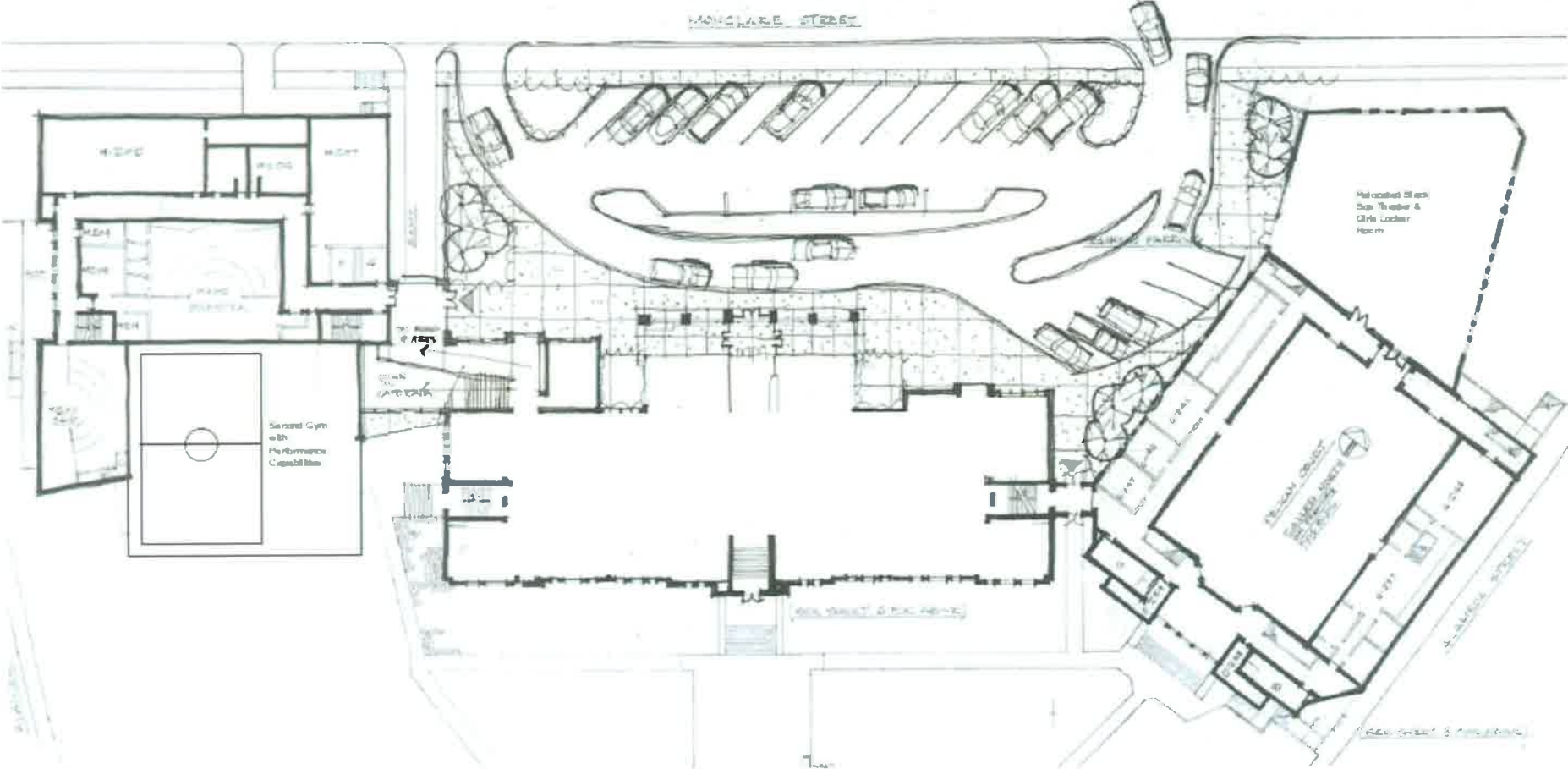

This aerial sketch gives a sense of the effect of the removal of the 1950's and 1960's additions. The public entry now faces Monclare with drop off and a modest amount of parking.

EXTERIOR CONCEPT



Tilting the model, gives a sense of the overall site from the current main facade.

HISTORICAL PLANNING CONTEXT

40+ member planning committee formed in 2011

Committee recommended plan in Spring 2012

Plan included work at all sites but also modest Phase 1 investment at KUHS including:

- Demolition of 1950's additions (reduces system upgrade costs & has less than half the students it once held)
- Critical systems upgrades
- Relocation of offices to Monclare side
- Development of 30+/- parking and drop off an entry toward Monclare
- Hard link to Cafeteria / Arts Building
- Expansion of MP Space to full gym

Fall 2013 – Re-visiting KUHS Plan to be more comprehensive for:

- All building systems
- All building finishes (interior and exterior)
- Instructional areas
- Locker room renovations
- Performance space(s)

EXTERIOR CONCEPT



This view is the proposed new Public Entry facing Monclare with the 50's and 60's additions removed. The facade would be classical to match the opposite face. At the far right, the re-worked link is shown leading to the Cafeteria / Music Building

EXTERIOR CONCEPT



This view of the current main facade shows that what the community cares most about is preserved. The students would still use this as a primary entry point given the location of their parking area.

EXTERIOR CONCEPT



This view shows the existing main façade is unaltered – save for the replacement windows and the re-pointing of the masonry. What IS altered is the Cafeteria / Music Building shown at the left, with the expansion to house the second gymnasium and the re-work of the link between the two buildings.

INTERIOR CONCEPTS

FLOOR BY FLOOR TRANSFORMATION BIG IDEA CONCEPTS

- **SUPPORT THE PLC ENVIRONMENT**
- **INTERIOR TRANSPARENCY (blue interior walls)**
- **PERSONALIZATION OF SPACE**
- **MIX OF FORMAL AND INFORMAL LEARNING**
- **OPEN AND FLEXIBLE SPACES (yellow zones open to corridors)**
- **PRESENTATION OPPORTUNITIES**
- **SUPERVISION THROUGH DISPERSED STAFF IN OPEN ACCESSIBLE SPACES**
- **TECHNOLOGY RICH ACCESS THROUGHOUT**
- **PEER-TO-PEER & COLLABORATIVE AREAS**
- **INDEPENDENT (yet visible) STUDY AREAS**

CONVERTING EXISTING SPACES

Traditional

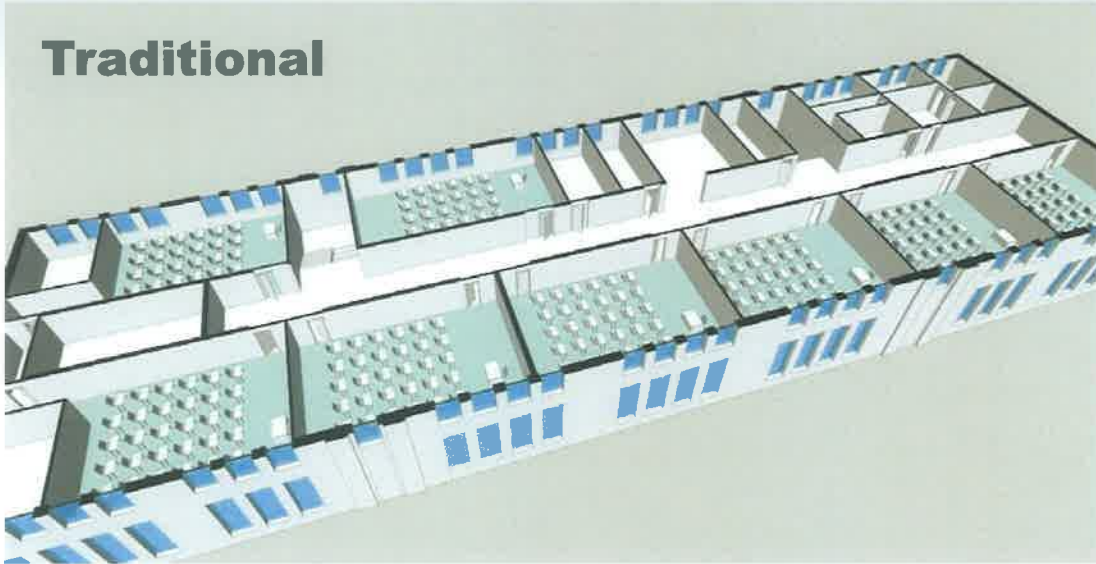

21st Century

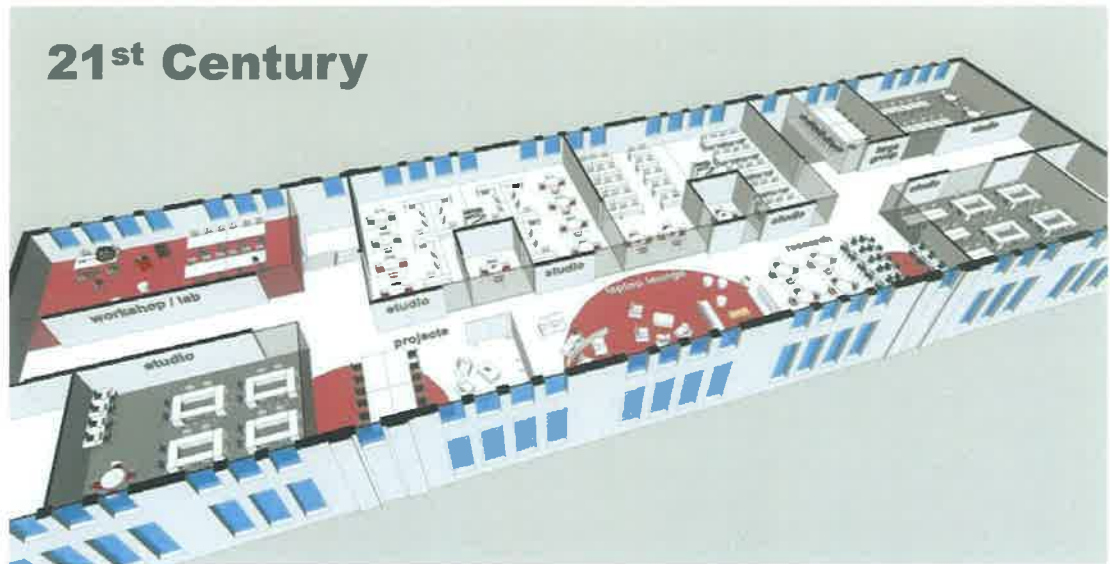

21ST CENTURY LEARNING ENVIRONMENTS



- **PROJECT –BASED LEARNING / CRITICAL THINKING**
- **COMMUNITY INVOLVED**
- **PERSONALIZED**
- **TECHNOLOGY RICH**
- **COLLABORATIVE**
- **FLEXIBLE**